

Conductive Plastic Angle Sensor

**CPP-45SB**

- Conductive Plastic Angle Sensor
- Effective Electrical Travel : 350°
- Independent Linearity :  $\pm 0.3\%$  (Special Linearity :  $\pm 0.1\%$ )
- Servo Mount
- Drip Proof

## 【Material】

- Housing : Aluminum
- Shaft : Stainless Steel
- Ball Bearing : Stainless Steel

## ■Dimension [mm]

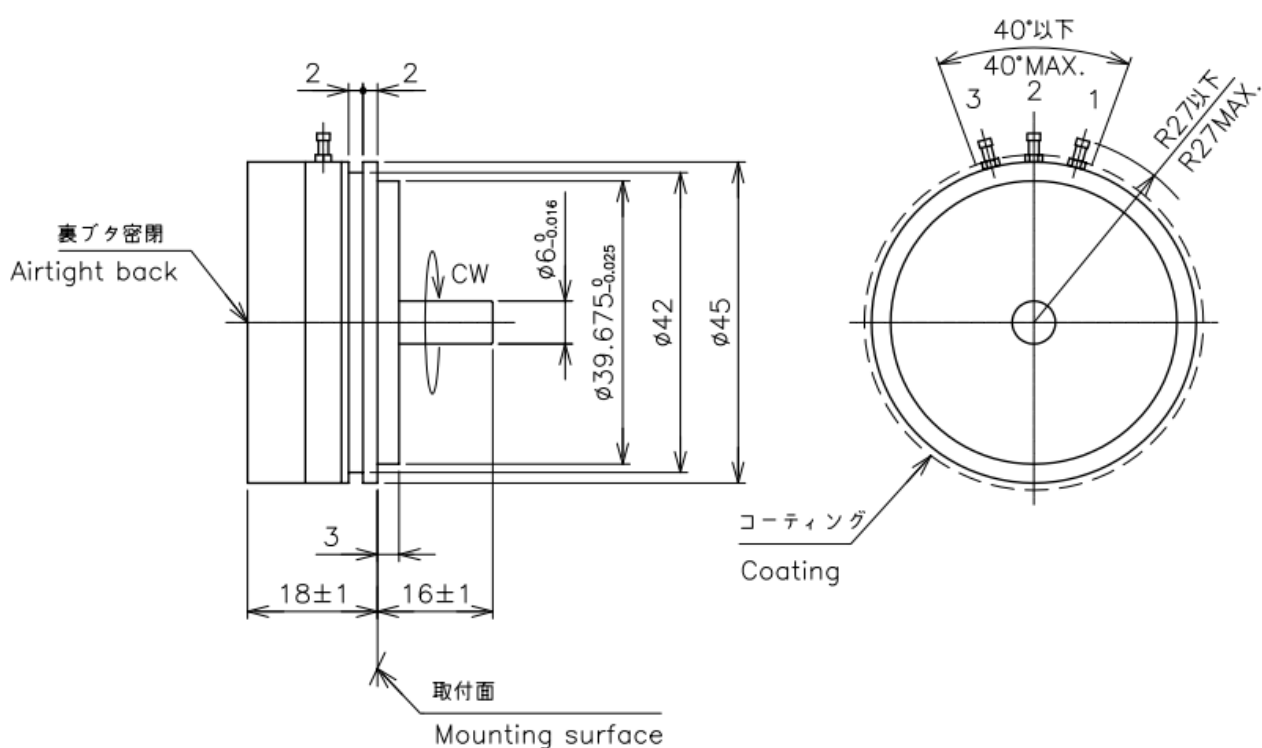

## ■Output Characteristics

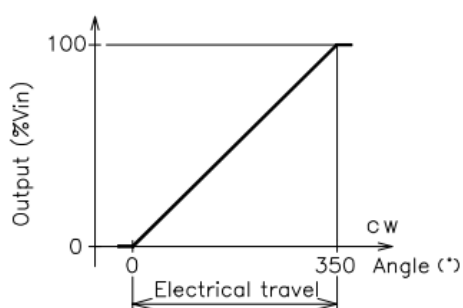

## ■Schematic

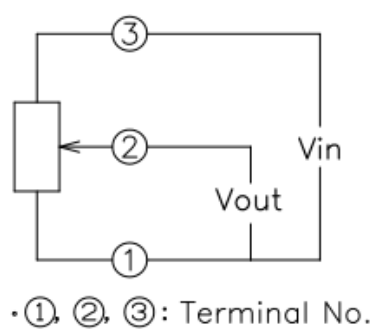

## ■Mounting

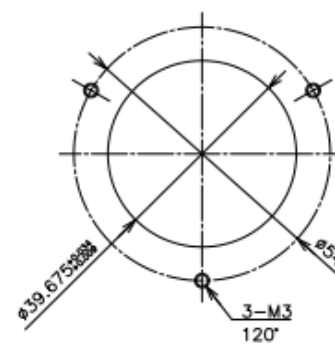

Servo Mount

<b>【Model No.】</b>	<b>CPP-45SB</b>
--------------------	-----------------

**【Electrical Specifications】**

Effective Electrical Travel	350 +2, -3	°
Total Resistance	0.5, 1, 2, 5, 10, 20	kΩ
Total Resistance Tolerance	±15	%
Independent Linearity	±0.3	%
Rated Dissipation	3/70°C	W
Output Smoothness	MAX. 0.1	%
Insulation Resistance	MIN. 100/DC1000V	MΩ
Dielectric Strength	AC1000/1 Minute	V
Temperature Coefficient of Resistance	±400	ppm/K

**【Mechanical Specifications】**

Total Mechanical Travel	360 Endless	°
Torque	MAX. 15	mN·m
Thrust Load Tolerance	3	N
Radial Load Tolerance	9	N
Mass	Approx. 60 (Additional 10g/add one gang)	g

**【Environmental Specifications】**

Life Cycles	10 Million	Cycle
Category Temperature Range	-30 - +90	°C
Storage Temperature Range	-30 - +90	°C
Vibration	150m/s <sup>2</sup> 2000Hz 3 axis 2 hours each	
Shock	500m/s <sup>2</sup> 11ms 6 directions 3 times	
IP Level	IP54	

**■Options**

- Multi Ganging : up to 2 sections
- Additional Center Tap :
  - C.T(A) ... No shorted angle
  - C.T(B) ... Shorted on Tap (Shorted angle 1~5° )
- Screw Mount (M3 Tapped Holes) : CPP-45SB-3

**■Accessories**

Mounting Cleats : 3 pieces

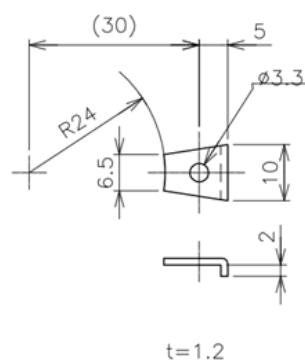
**■Handling Instruction**

- To avoid burnout of resistive element, do not supply more than 1mA current to terminal 2.
- Miswiring might cause burnout of resistive element.
- To reduce sliding noise, add load resistance should be more than 100times and less than 1000times of total resistance.
- Slight continuous vibration such as dither might cause short lifetime of the sensor.